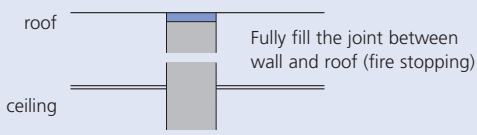
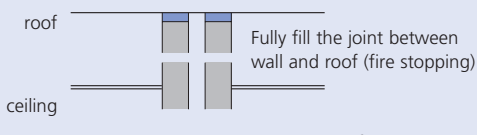
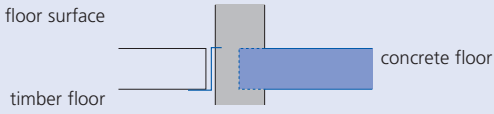
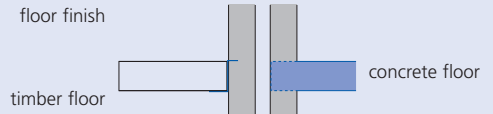

party wall details in masonry

Wall type 1	Wall type 2
<p>reduce mass of wall above ceiling to 150kg/m² (1) (2)</p>  <p>Fully fill the joint between wall and roof (fire stopping)</p>	<p>reduce mass of wall above ceiling to 150kg/m² (1) (2)</p>  <p>Fully fill the joint between wall and roof (fire stopping)</p> <p>maintain cavity construction in roof space to the underside of roof covering</p>

Ceiling/roof void construction details at junctions

Wall type 1	Wall type 2
<p>timber joists on hangers or built in (no air paths, seal well) concrete floors may be carried through</p>  <p>it is recommended that joists are supported on joist hangers and not built into separating walls</p>	<p>timber joists on hangers or built in (no air paths, seal well) concrete floors may be carried through to the cavity face of each leaf concrete ground floor may be continuous</p> 

Intermediate and ground floors construction details at junctions

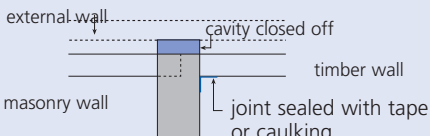
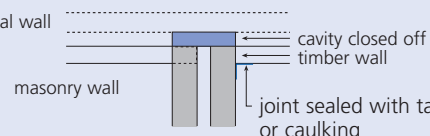
Wall type 1	Wall type 2
<p>(3) (4) unless openings are present; • of not less than 1m high • on both sides of the separating wall • within 700mm of the face of the separating wall on both sides</p>  <p>external wall</p> <p>cavity closed off</p> <p>timber wall</p> <p>masonry wall</p> <p>joint sealed with tape or caulking</p>	<p>(3) (4) except where party wall 2B is used when no min. mass is required (5). Use only butterfly or proprietary wall ties for use in supporting walls</p>  <p>external wall</p> <p>cavity closed off</p> <p>timber wall</p> <p>masonry wall</p> <p>joint sealed with tape or caulking</p>

External walls construction details at junctions

Notes:

1. Where a 12.5mm ceiling is provided with sealed joints
2. Where lightweight blocks are adopted with a density less than 1200kg/m³ seal one side of the wall with cement paint or a plaster skim
3. External walls can be bonded together with the party wall or, butted up and tied at max. 300mm centres
4. The external wall (inner leaf) should have a mass of at least 120kg/m²

5. Where a cavity wall has an inner timber frame construction it should, abut the party wall and be tied at max. 300mm centres vertically having all joints sealed.

Where the external wall has a cavity, the cavity should be sealed with a flexible closer eg. mineral wool.

Fill all joints between blockwork units and ensure that all perimeter joints are fully caulked.

party wall details in masonry

(continued)

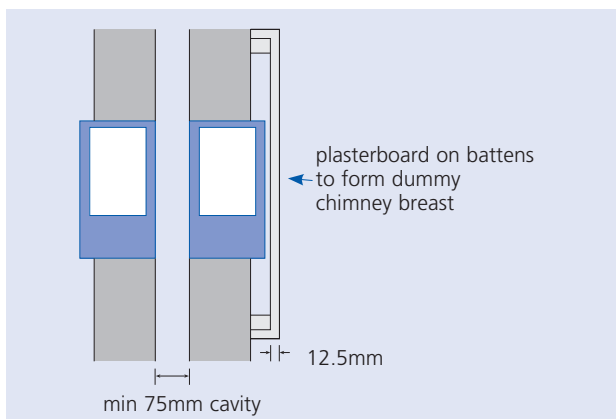

Gas flue blocks in separating walls

Gas Flue Blocks in Separating Walls

Gas flue blocks must be positioned within separating walls so as not to reduce the effectiveness of the sound reduction factor across the wall.

Attention must be paid to the minimum cavity width of the wall and the density of the blockwork. (See diagrams above) Note. Where this minimum cavity width cannot be maintained, the cavity must include a proprietary cavity slab between the back to back flue liners.

The flue blocks must be installed on a suitable bedding compound, care must be taken to ensure all perpendicular joints are fully filled with mortar.

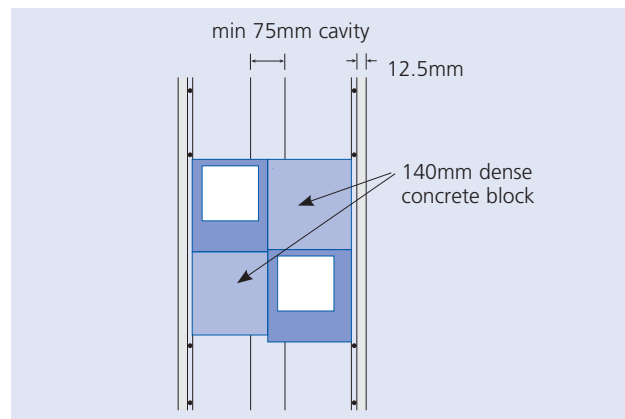

Gas flue blocks in separating walls

Points to watch

1. Fill and seal all joints with mortar to achieve the necessary mass and avoid air paths.
2. Lay bricks frog up/ fill in bricks and in a bond including headers (if a solid wall).
3. Control sound paths around walls to reduce flanking transmission
4. Maintain cavity to underside of roof.
5. Connect leaves only where necessary for structural reasons.
6. Use only butterfly pattern ties (limited to cavities 50-75mm masonry thickness of 90mm min), or proprietary ties approved for party wall use.
7. If external walls are to be filled with an insulating material the material should be prevented from entering the cavity in the separating wall by a resilient cavity closer (eg. mineral wool).
8. Avoid sockets/switch boxes/chases in separating walls.

Zurich Building Guarantee

Zurich House, 2 Gladiator Way, Farnborough, Hampshire, GU14 6GB.

Telephone 01252 377474 Fax 01252 372989 Email building.guarantee@uk.zurich.com www.zurich.co.uk/buildingguarantee

Zurich Building Guarantee is a trading name of Zurich Insurance plc. A public limited company incorporated in Ireland. Registration No. 13460.

Registered Office: Zurich House, Ballsbridge Park, Dublin 4, Ireland. UK Branch registered in England and Wales Registration No. BR7985.

Authorised by the Irish Financial Regulator and subject to limited regulation by the Financial Services Authority. Details about the extent of our regulation by the Financial Services Authority are available from us on request. FSA registration number 203093. These details can be checked on the FSA's register by visiting their website www.fsa.gov.uk/register or by contacting them on 0845 606 1234.

Communications may be monitored or recorded to improve our service and for security and regulatory purposes. © Copyright – Zurich Insurance plc 2009. All rights reserved. Reproduction, adaptation or translation without prior written permission is prohibited except as allowed under copyright laws.